



ホルン
取扱説明書

日本語

Horn
Owner's Manual

English

Waldhorn
Bedienungsanleitung

Deutsch

Cor
Mode d'emploi

Français

Trompa
Manual de instrucciones

Español

Trompa
Manual de instruções

Português

圓号
使用手冊

中文

Валторна
Руководство пользователя

Русский

호른
사용설명서

한국어



このたびは、ヤマハ管楽器をお買い上げいただき、まことにありがとうございます。
楽器を正しく組み立てて性能をフルに発揮させるため、また永く良い状態で楽器を
お使いいただくために、この取扱説明書をよくお読みください。

P.13

You are now the owner of a high quality musical instrument. Thank you for choosing Yamaha.
For instructions on the proper assembly of the instrument, and how to keep the instrument in opti-
mum condition for as long as possible, we urge you to read this Owner's Manual thoroughly.

P.19

Sie sind nun der stolze Besitzer eines hochwertigen Musikinstruments. Vielen Dank, dass Sie sich für
ein Instrument der Marke Yamaha entschieden haben. Um mit den Handgriffen zum Zusammen-
setzen und Zerlegen des Instruments vertraut zu werden und dieses über Jahre hinweg in optimalem
Zustand halten zu können, raten wir Ihnen, diese Anleitung aufmerksam durchzulesen.

P.33

Vous êtes dès à présent le propriétaire d'un instrument de musique de haute qualité.
Nous vous remercions d'avoir choisi Yamaha. En ce qui concerne les instructions relatives à un assem-
blage adéquat de l'instrument et sur la façon de garder l'instrument dans des conditions optimales aussi
longtemps que possible, nous vous conseillons vivement de lire entièrement le présent Mode d'emploi.

P.47

Usted es ahora propietario de un instrumento musical de alta calidad. Le agradecemos su elección
de un instrumento Yamaha. Le aconsejamos que lea todo este manual de instrucciones para ver las
instrucciones para el montaje correcto del instrumento y para aprender a conservar el instrumento en
óptimas condiciones durante tanto tiempo como sea posible.

P.61

Agora você é o proprietário de um instrumento musical de alta qualidade. Obrigado pela sua
escolha de um instrumento Yamaha. Para instruções da montagem correta do instrumento, e
de como conservar o instrumento em condições ideais pelo maior tempo possível, pedimos
que você leia este Manual do Proprietário por completo.

P.75

现在您已经是高品质乐器的主人了！在此，我们衷心感谢您选择雅马哈乐器，
同时也恳请您完整阅读该使用手册，从而可以充分了解有关乐器正确组装及
如何使您的乐器尽可能长久地处于最佳状况的使用说明。

P.89

Вы стали обладателем высококачественного музыкального инструмента. Благодарим Вас
за выбор продукции Yamaha. Для получения инструкций по правильной сборке данного
инструмента и его длительном хранении в оптимальных условиях мы настоятельно реко-
мендуем Вам внимательно прочитать настоящее руководство.

P.103

야마하 악기를 구입해 주셔서 감사합니다. 악기의 알맞은 조립 방법 및 보관을 위
해 본 사용설명서를 반드시 읽어주시기 바랍니다.

P.117

Horn

Owner's Manual

Precautions Please read before using

The precautions given below concern the proper and safe use of the instrument, and are to protect you and others from any damage or injuries. Please follow and obey these precautions.

If children are using the instrument, a guardian should clearly explain these precautions to the child and make sure they are fully understood and obeyed. After reading this manual, please keep it in a safe place for future reference.

■ About the Icons

 : This icon indicates points which should be paid attention to.

 : This icon indicates actions that are prohibited.

Caution

Disobeying the points indicated with this mark may lead to damage or injury.

 **Do not throw or swing the instrument.**
The mouthpiece or other parts may fall off hitting other people. Always treat the instrument gently.

 **Keep the oil, polish, etc., out of children's mouths.**
Keep the oil, polish, etc., out of children's reach and do maintenance when children are not present.

 **Keep small parts out of the reach of infants.**
Your children may accidentally swallow them.

 **Be aware of climatic conditions such as temperature, humidity, etc.**
Keep the instrument away from heat sources such as heaters, etc. Also, do not use or store the instrument in any extreme conditions of temperature or humidity. Doing so may result in damage to key balance, linkage, or pads, resulting in problems during performance.

 **Never use benzene or thinner for maintenance on instruments with a lacquer finish.**
Doing so may result in damage to the finish's top coat.

 **Take care not to disfigure the instrument.**
Placing the instrument where it is unstable may cause the instrument to fall or drop resulting in disfigurement. Take care as to where and how you place the instrument.

 **Do not modify the instrument.**
Besides voiding the warranty, modification of the instrument may make repairs impossible.

In regards to brass instruments with a plate finish, the color of the finish may change over time however, it should be of no concern in regards to the instrument's performance. Discoloration in its early stage can easily be removed with maintenance. (As discoloration progresses, it may be difficult to remove.)

* Please use the accessories that are specified for use with the particular type of finish found on the instrument. Also, metal polishes remove a thin layer of the finish's top coat which will make the finish thinner. Please be aware of this before using polish.

Nomenclature

■ F Single

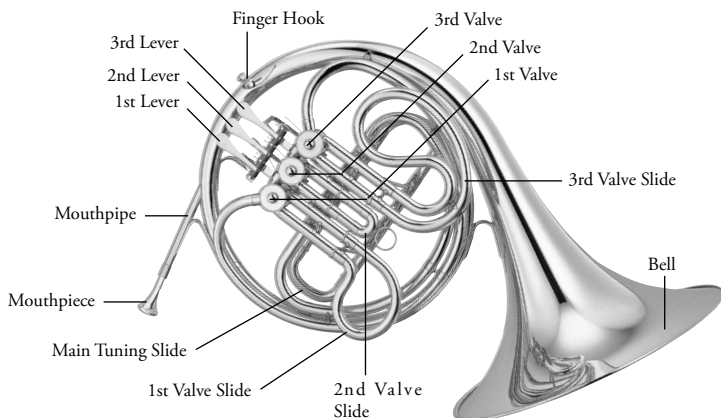

■ B \flat Single

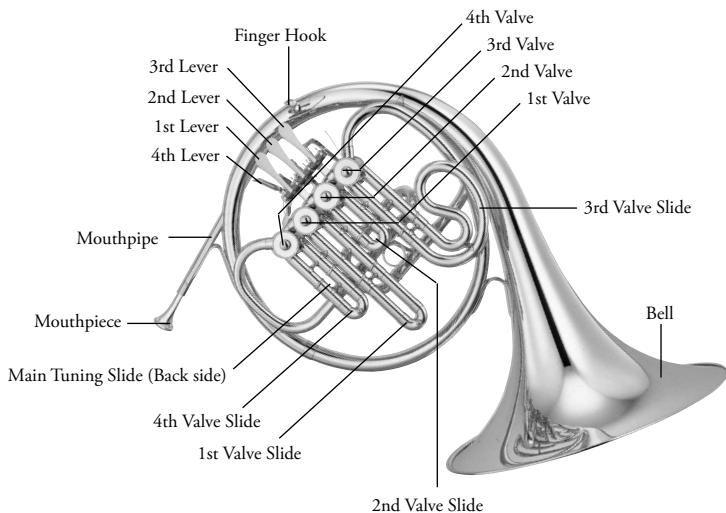

■ F/B \flat Full Double

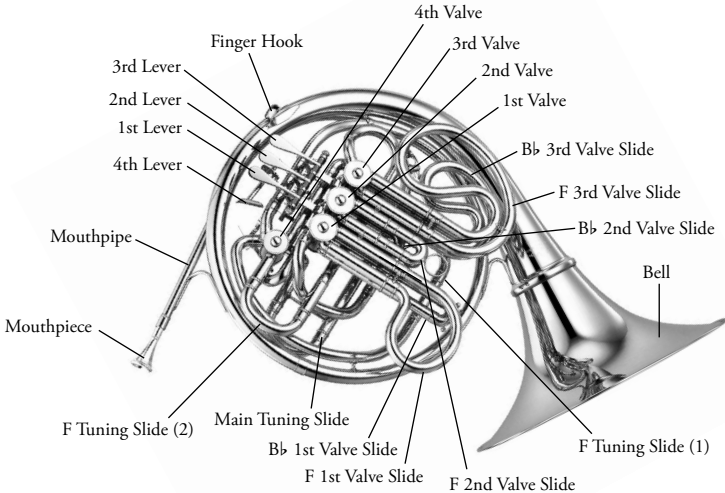
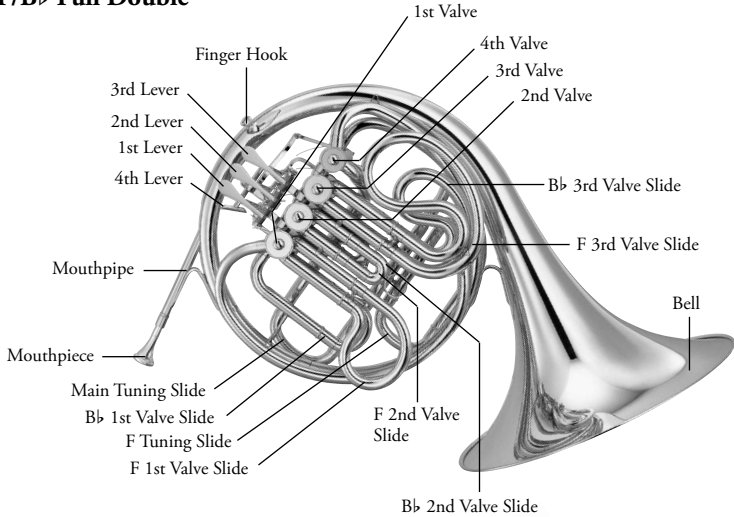

* Specifications and/or design may change without notice for reasons of improvement.

Handling the Instrument

The instrument is made of a thin metal so please handle it with care. Do not apply any excessive force to the instrument, or bump it in a manner that will dent or damage it.

■ Attaching the Screw-On Bell

When attaching the screw-on bell, always hold the bell by its mid section and assemble. Do not over-tighten.



■ Lubrication

Oiling the Rotors

1. While holding the levers down, remove the valve slides then apply rotor oil to the rotors as shown in the illustration below (a few drops per rotor).

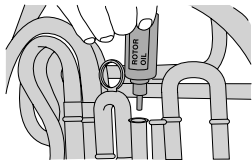

- * Apply oil if the lever does not work smoothly.
- * When applying oil, do not let the oil mix with the slide grease adhering to the valve slide's interior.

2. Move the levers so that the oil is spread evenly.

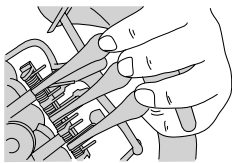

■ Attaching the Mouthpiece

Gently insert the mouthpiece into the mouthpipe.

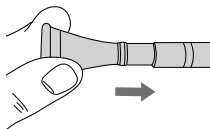

- * Never force the mouthpiece into the mouthpipe. The mouthpiece may become stuck in the mouthpipe.

Tuning

Use the main tuning slide to make sure that the instrument is in tune before playing.

Since temperature has an effect on the instrument's pitch, blow some warm air through it to warm it up before tuning. The amount of tuning slide adjustment needed to get the horn in tune will vary between individuals so there is no standard rule to follow (however, at 68°F pulling the main tuning slide out about 0.6" should more or less tune the instrument to A=442Hz).

Take notice that when temperatures are warmer, the main tuning slide should be pulled out a little more, while cooler temperatures will require that you push the slide in. Also, the position and angle of your right hand in the bell will have an influence on pitch as well.

Single Horns

Slide the main tuning slide in or out to tune the instrument.

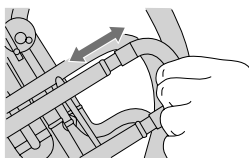

Double Horns

1. Use the main tuning slide to tune the B \flat side.

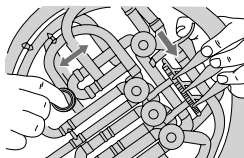
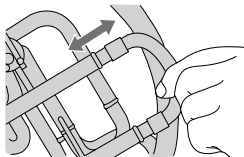

* Instruments with a B \flat tuning slide should tune with the main tuning slide as well.

2. Use the F tuning slide to tune the F side of the instrument.

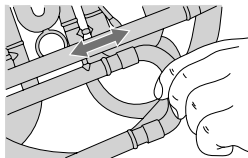

Tuning

- 3.** Pull out each of the valve slides between 1/5-2/5 inch. When pulling out the slides, make sure that the lever corresponding to the slide is depressed.

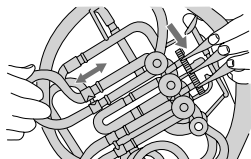

- 4.** When the hand stopping technique is used, the 4th valve on the YHR-322II lets you use regular fingerings in combination with this technique. Also, when setup as shown in the illustration below, it can be used in the same way as the 2nd valve, lowering the pitch a half-step.

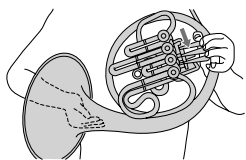
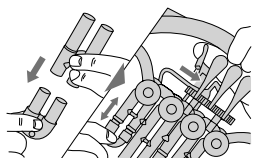

*** What is Gestopft or hand stopping?**

This is a technique used on F Single or Double Horns (using F side) where the hand is placed further into the bell to raise the horn's pitch by a half-step and change the tone of the instrument. But doing so requires the player to transpose the score down a half step to produce the correct pitch.

The 4th valve on the YHR-322II compensates for the difference in pitch when using the hand stop technique, so you can read the score as is and still get the correct pitch.

■ Caring for your instrument after playing

To keep your instrument both looking and playing well, make sure you take proper care of it after you have finished playing. When caring for the instrument, place it on a table or, hold it securely in your hands, taking care not to drop it.

● Valve Slide Maintenance

1. Remove the valve slides to remove any moisture.

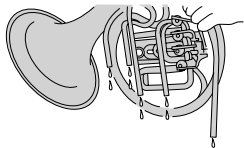

* Removing the valve slide without holding the corresponding lever down creates a drop in air pressure within the pipe, creating a suction that can result in poor rotor function or damage to the inside of the pipe.

2. If the instrument has a water key, remove moisture from the water key too.



* The valve slides are made of brass or nickel silver, which are both excellent at resisting corrosion. However, corrosion may appear if moisture is left in the instrument for an extended period of time. Please use caution.

● Body Maintenance

Use a polishing cloth to gently wipe the instrument's surface. If dirt or tarnish is obvious, the following products can be used.

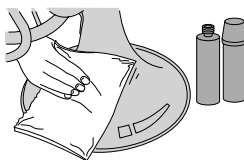

For lacquer finishes...

Polishing cloth + lacquer polish

For silver plate...

Silver cloth + silver polish

For a beautiful shine, buff the instrument with a silicone cloth.

■ Once a Week Maintenance

● Rotor Maintenance

1. Remove the cap on the rotor valve and apply a little rotor spindle oil to the rotor bearings.

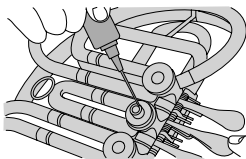

* After applying the oil, remove the excess oil. After applying oil, replace the cap and move the lever a few times to distribute the oil evenly.

2. Apply a little rotor spindle oil to the rotor spindle and receiver.

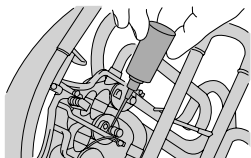

3. Apply a little lever oil to each linkage of the lever assembly.

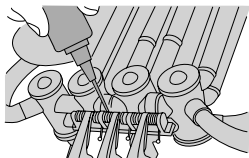

* Remove excess oil and use a gauze cloth to clean the smaller parts.

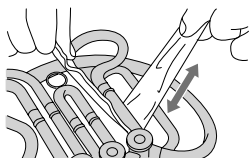

■ Once or Twice a Month Maintenance

● Valve Slide Maintenance

1. Depress the valve levers and remove the valve slides.

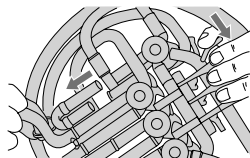

2. Wrap a cleaning rod with a gauze cloth leaving no bare metal exposed, and remove dirt from the valve slides and the insides of the outer pipes.

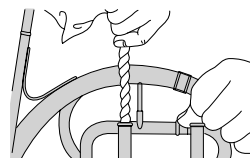
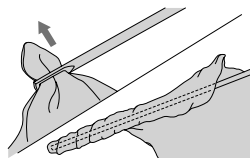

3. Use the gauze to remove dirt from the surface of the valve slide, then apply a little slide grease.

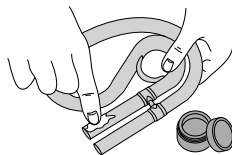

4. Slide the valve slide in and out a few times to distribute the grease evenly. Then wipe off any extra grease that comes off the slide.

■ Twice Yearly Maintenance

● Cleaning the Instrument

1. Prepare a brass soap water solution using between 10 to 15 parts warm water (78°F to 88°F) and 1 part brass soap. Before putting the instrument into the solution, remove the valve slides.
2. Apply some soap water solution to the brush on the end of flexible cleaner and use the cleaner to clean the inside of the instrument's tubing.

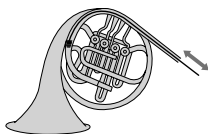

3. After cleaning the instrument, use clean water to thoroughly rinse out the dirt and soap.

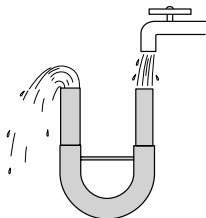

4. After completely removing all moisture with a gauze, apply oil and grease.

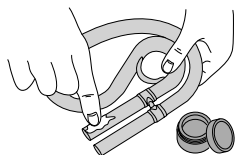
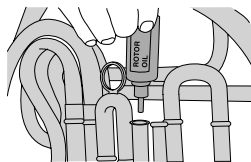

Take Care When Cleaning Inside of the Instrument

Never dismantle the rotors. Also, when rinsing the tubing with water, run water through the main tuning slides in the opposite direction of the airflow. If water is run through the instrument from the mouthpiece, dirt can become clogged in the valves causing the valves to become sluggish.

5. Apply some soap water solution to a mouthpiece brush and insert it into the throat to clean the mouthpiece, then thoroughly rinse it out with clean water.

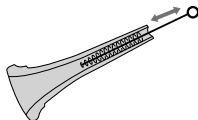

Adjusting the Rotary String and the Lever Function

Winding and adjusting the rotary string is difficult for beginner players. Please consult with a wind instrument technician.

- **Wind the string as shown in the illustration below, and tighten the string stopper screw.**

Wind the string around the screw in the same direction that the screw tightens. After winding, use the String Stopper Screw B to adjust the lever's height.

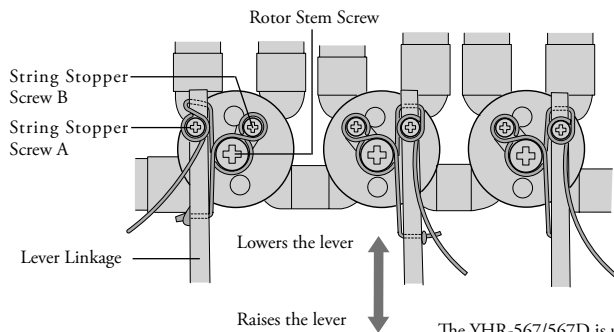

The YHR-567/567D is used in this illustration.

You can change the stroke from long to short by changing the position of the bearing stopper screw on the YHR-567GDB. (Open F is shown in the illustration.)

* When the bearing stopper screw is installed near the rotating center, the stroke will become short. When the screw is installed far from the rotating center, the stroke will become long.

The 4th lever on the YHR-871/D, YHR-671/D, YHR-668/D, YHR-567/D, etc., can be adjusted to better fit the players hand size and position. Use a screw driver and adjust the lever length as shown in the illustration below.

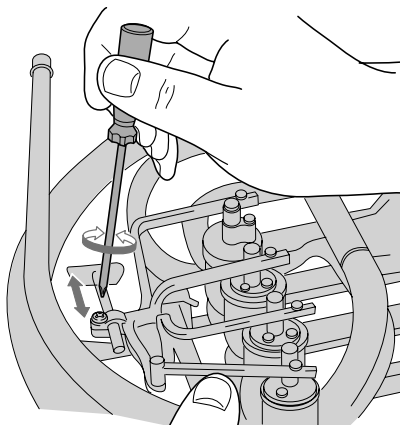
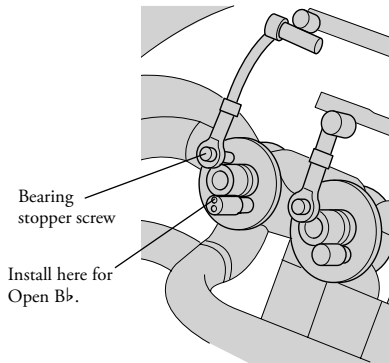

■ Switching the 4th Lever Function

● F/B \flat Double Horn

The Yamaha double horn is designed so that it normally plays in the key of F (open F) when the 4th lever is not depressed, and in the key of B \flat when the 4th lever is depressed. However, by re-configuring the linkage as shown in the illustration below, this function can be reversed so that the horn plays in B \flat (open B \flat) when the lever is not depressed, and in the key of F when the lever is depressed.

To use this setup, move the string and the string seat, then place the string over the string seat.

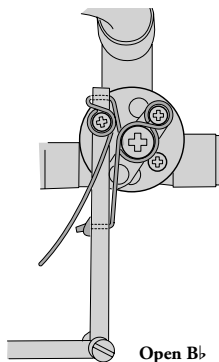
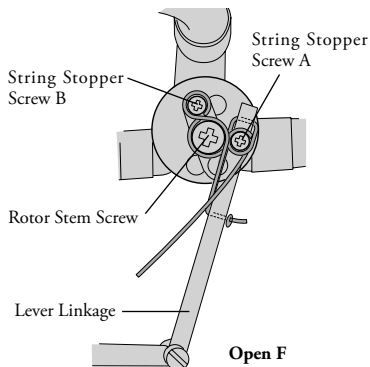

The YHR-567/567D is used in the illustration.

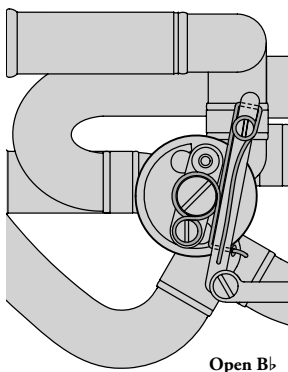
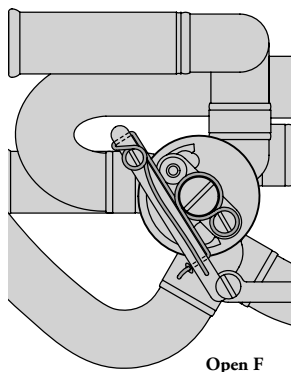

The YHR-668/668D is used in the illustration.

Options

● E \flat Crook (optional)

This optional main tuning slide is designed for the YHR-314II and transforms the single F horn into an E \flat horn so that you can play E \flat parts without transposing.

The crook is designed so that the horn fits in the case when it is attached.

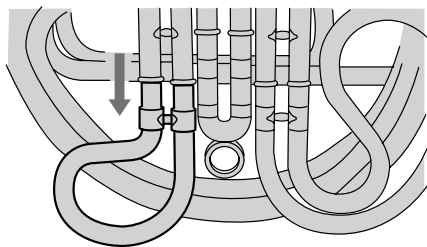
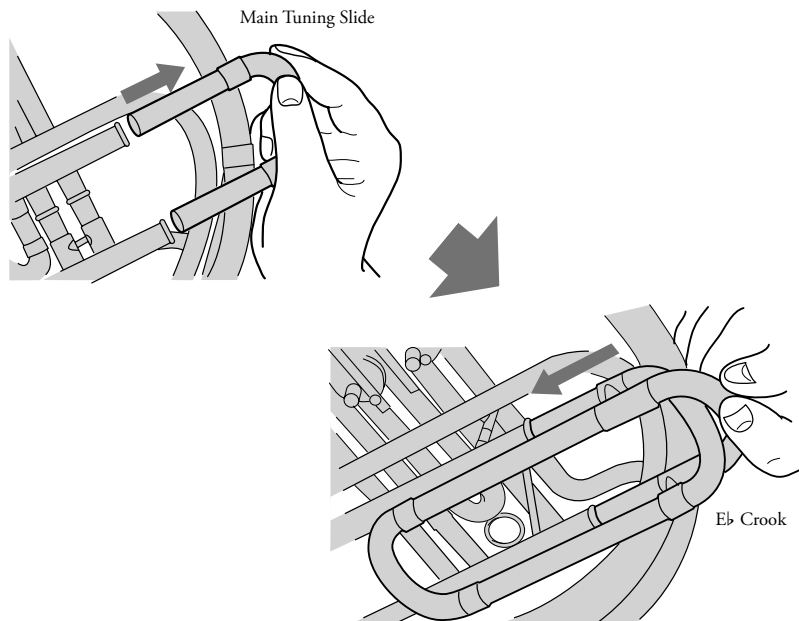

When using the E \flat crook, the 1st through 3rd valve tuning slides should be pulled out a little.

● F Natural Slide (optional)

Attached to the YHR-322II's 4th valve slide the F natural slide offers the sound of an open F horn. It enhances clarity in the mid-low range such as C (actual F) or G (actual C) and stable intonation. The F Natural Slide is designed so that the horn fits in the case when attached.

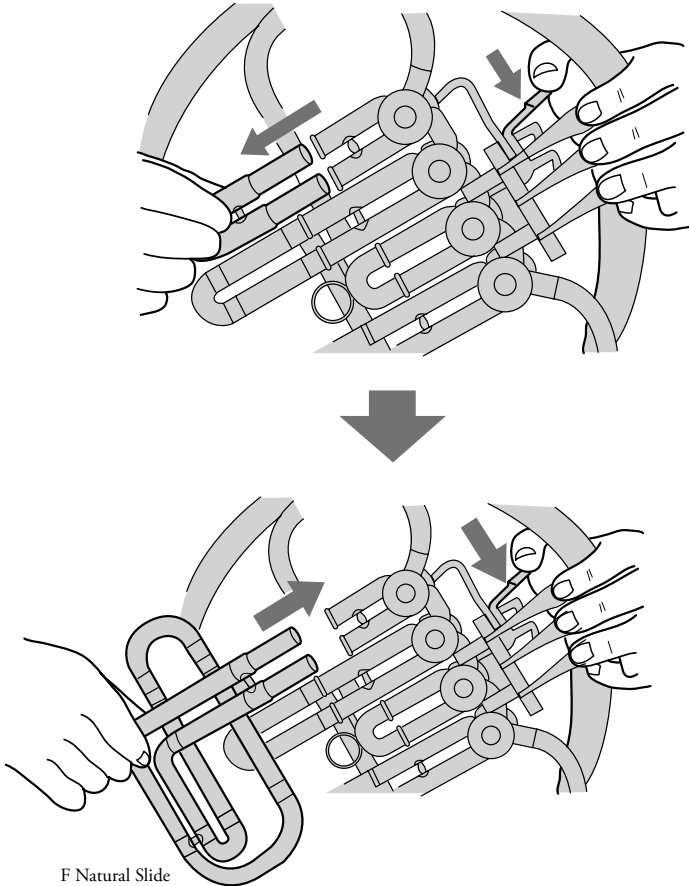

Troubleshooting

Tone is not clear and pitch is poor.

- **Dirt has accumulated inside the tubing.**
→ Use the procedure described in the "Valve Slide Maintenance" section and wash out the insides of the tubing.
- **The water key cork is cracked causing air to leak.**
→ Replace the water key cork with a new one.
- **The mouthpiece is loose and rattles, and air is leaking from around the mouthpiece.**
- **There is a large dent in the tubing, and air is leaking from the ferrules where the tubing connects.**
- **There is a foreign object in the tubing.**
- **Holes in the rotors are not aligned with holes in the valve casing branches.**
→ Contact the dealer from whom you purchased the instrument.

The rotors are sluggish.

- **The string is loose.**
→ Use a screwdriver and tighten the string.
- **Dirt has accumulated between the valve casing and rotor.**
- **The valve casing is deformed.**
- **The rotary valve was disassembled, then reassembled.**
→ Contact the dealer from whom you purchased the instrument.

The valve slide is stuck and can not be removed. The slide is sluggish.

- **Dirt or dust has accumulated between the outer and inner slides and the valve slide is damaged.**
→ Remove dirt from the slides then apply some slide grease.
- **Dropping or hitting the slide has created a dent, or the slide was bent while cleaning.**
→ Contact the dealer from whom you purchased the instrument.

The screw is too tight and can not be loosened.

- **The screw is corroded.**
- **Hitting the screw has damaged it.**
→ Contact the dealer from whom you purchased the instrument.

The mouthpiece can not be removed.

- **The instrument was dropped or hit with the mouthpiece attached. Or, the mouthpiece was inserted with too much force.**
- **The instrument was left for a long period of time with the mouthpiece inserted in the instrument.**
→ Contact the dealer from whom you purchased the instrument.

The instrument makes an abnormal sound when played.

- **Solder on the instrument has come loose.**
- **There is a foreign object in the tubing.**
→ Contact the dealer from whom you purchased the instrument.



F シングル

F Single Horn

F-Einfachhorn

Cor en Fa

Trompa sencilla de F

Trompa simples em Fá

F 調単一調性法国圓号

Одиная валторна в строе F

F 싱글 호른

A



B♭ シングル

B♭ Single Horn

B-Einfachhorn

Cor en Si♭

Trompa sencilla de B♭

Trompa simples em Si♭

降 B 調単一調性法国圓号

Одиная валторна в строе B♭

B♭ 싱글 호른

B



in F

●: 押さえる /Close/Geschlossen/Fermé/Cerrado/Fechado/ 按下 /Закрыт / 닫기

○: 放す /Open /Offen /Ouvert /Abierto /Aberto / 放开 /Открыт / 열기

		Bass Clef										
		Notes: F, G, A, B♭, C, D, E, F, G, A, B♭, C										
A	3	○								●	●	●
	2	○								●	○	●
	1	○								●	●	○
B	4	○	○	○ ○	○	○	○					
	3	●	●	○ ●	○	○	○					
	2	○	●	● ○	○	●	○					
C	1	●	○	● ○	●	○	○					
	4	○ ●	●	● ●	●	●	●	○	○	○		
	3	○ ●	●	○ ●	○	○	○	●	●	●		
	2	○ ○	●	● ○	○	●	○	●	○	○	●	
	1	○ ●	○	● ○	●	○	○	●	●	○		

F/B \flat フルダブル

F/B \flat Double Horn

F/B-Doppelhorn

Cor double Fa/Si \flat

Trompa doble de F/B \flat

Trompa dupla Fá/ Si \flat

F/降B 调双管法国圆号

Двойная валторна в строе F/B \flat

F/B \flat 더블 호른



C

フルダブルホルンの第4レバーは、F管とB \flat 管の切り替えに使用します。工場出荷時は、第4レバーを押すと、F管からB \flat 管に切り替わるようにセットされています。

The 4th lever on full double horns is used to switch between the F and B \flat sides of the horn. When shipped from the factory, this valve is set so that the horn changes from the F side to the B \flat side when the 4th lever is pressed.

Der vierte Hebel von echten Doppelhörnern dient zum Umschalten zwischen der F- und B-Seite des Horns. Bei der Auslieferung des Instruments ist dieses Ventil so eingerichtet, dass das Horn beim Betätigen des Hebels von der F-Seite zur B-Seite wechselt.

La 4ème palette des cors doubles sert à faire passer l'instrument de Fa en Si \flat . Par défaut, elle est configurée de telle sorte que le cor joue en Fa lorsqu'elle n'est pas enfoncée et qu'il joue en Si \flat lorsqu'elle est enfoncée.

La cuarta espátula de las trompas dobles completas se emplea para cambiar entre los lados de F y B \flat de la trompa. Cuando la trompa sale de fábrica, este cilindro está ajustado para que la trompa cambie del lado de Fa al de B \flat cuando se presiona la cuarta espátula.

A quarta chave da trompa dupla é usada para alternar entre os lados Fá e Si da trompa. Quando sai da fábrica, está chave esta ajustada para o lado Fá, ativando o lado si quando a quarta chave é acionada.

双管法国圆号的第四连杆用于F调与降B调之间的转换。出厂设置为：按下第四连杆时，圆号从原来的F调改发降B调。

4-я клавиша на двойных валторнах используется для переключения между строями F и B \flat . При поставке с завода клапан настроен таким образом, что переключение между F и B \flat осуществляется нажатием 4-й клавиши.

풀 더블 호른의 4th 레버는 호른의 F 및 B \flat 사이드 간의 전환을 위해 사용됩니다. 공장 출고 시, 본 밸브는 4th 레버를 누를 경우 F 사이드에서 B \flat 사이드로 바뀌도록 설정된 상태로 출고됩니다.



フィンガリングチャート /Fingering Chart/Griffabelle/Tablature/

A	3	○	●	○●	○	○	○	○	○	○	○
	2	○	●	●○	○	●	○	●	○	○	●
	1	○	○	●○	●	○	○	○	●	●	○
B	4	●○	○	○	○	○	○	○	○	○	○
	3	●●	●	○●	○	○	○	○	●	○●	○
	2	●○	●	●○	○	●	○	○	●	○	○
1	○●	○	●○	●	○	○	○	○	●○	●	
C	4	○	○●	○●	○●	○●	○●	○●	○●	○●	○●
	3	○	●●	○	○	○	○	○	○	○	○
	2	○	●●	●●	○	○	●●	○	○	●●	○
	1	○	○	○	○	○	○	○	○	○	○

A

A	3	○	○	○	○	○	●○	○	○	○	○
	2	●	○	●	○	●	○	●	●	○	○
	1	○	○	●	○	○	○	●	○	●	○
B	4	○	○	○	○	○	○	○	○	○	○
	3	○	○	○	○	○	○	○	○	○	○
	2	○	○	○	○	○	○	○	○	○	○
1	○	○	○	○	○	○	○	○	○	○	
C	4	●	●	●	●	●	●●	●●	●●	●	●
	3	○	○	○	○	○	○	○	○	○	○
	2	○	○	○	○	○	○	○	○	○	○
	1	○	○	○	○	○	○	○	○	○	○

● : 押さえる / Close / Geschlossen / Fermé / Cerrado / Fechado / 按下 / Закрыт / 닫기
 ○ : 放す / Open / Offen / Ouvert / Abierto / Aberto / 放开 / Открыт / 열기



ヤマハ株式会社

〒430-8650 静岡県浜松市中区中沢町 10-1

Manual Development Group

© 2013 Yamaha Corporation

Published 06/2019 发行 POCP-A0

VDE1680