



# User Guide

Wireless Speaker

# TRUE X SPEAKER 3A

WS-X3A

EN

# CONTENTS

<b>INTRODUCTION</b>	<b>3</b>
About the provided manuals .....	3
Features .....	4
<b>ACCESSORIES</b>	<b>5</b>
Included accessories .....	5
<b>PART NAMES AND FUNCTIONS</b>	<b>6</b>
Top controls/Front .....	6
Rear/Bottom .....	8
<b>PREPARATION</b>	<b>9</b>
Charging the unit .....	9
Turning the unit on and off (standby) .....	10
<b>USING THIS UNIT AS A BLUETOOTH® SPEAKER</b>	<b>12</b>
Listening to audio from a Bluetooth device .....	12
<b>USING THIS UNIT AS A SURROUND SPEAKER</b>	<b>14</b>
Playing surround sound of the sound bar .....	14
<b>TROUBLESHOOTING</b>	<b>15</b>
When a problem occurs .....	15
Restarting or initializing (factory reset) the unit .....	23
List of lamp displays .....	24
<b>APPENDIX</b>	<b>26</b>
<b>SPECIFICATIONS</b> .....	<b>26</b>
<b>Trademarks</b> .....	<b>27</b>

# INTRODUCTION

## About the provided manuals

The following manuals are provided with this unit. Be sure to read each manual and keep the manuals that are included with the unit readily available for future reference.

### **Safety Guide (included with this unit)**

This document describes safety precautions. Be sure to read it before use.

### **Quick Guide (included with this unit)**

This document explains basic connection methods and operations.

### **User Guide (this manual)**

This guide explains all functions of this unit. This guide is only provided on the Yamaha website.



This content indicates “risk of injury.”

• **NOTICE**

Indicates points that you must observe in order to prevent product failure, damage or malfunction and data loss, as well as to protect the environment.

• **NOTE**

Indicates notes on instructions, restrictions on functions, and additional information that may be helpful.

- The illustrations and screens in the descriptions are for instructional purposes only.

## Features

This unit is a Bluetooth-supporting wireless speaker that you can take anywhere you like, to enjoy music whenever you want to.

In addition to using this unit as a Bluetooth speaker, you can also use it as a surround speaker for your home theater by connecting it to a Yamaha sound bar.

### ■ Using this unit as a Bluetooth speaker

You can use the unit as a Bluetooth speaker by connecting it to a smartphone or other mobile device.

In addition to high-quality audio playback, the unit also has the Clear Voice function that makes it easier to hear human voices such as dialog.

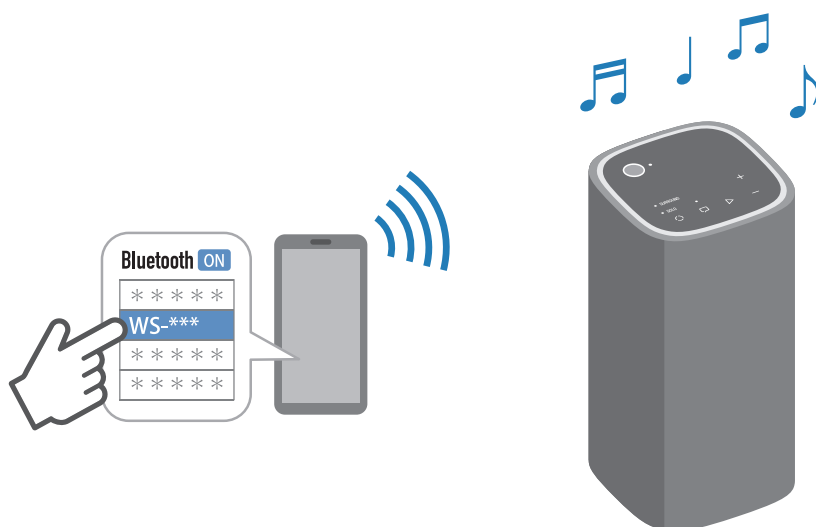

### Related links

[“Listening to audio from a Bluetooth device” \(p.12\)](#)

### ■ Using this unit as a surround speaker

The unit can be connected wirelessly to the sound bar. This unit is a portable type speaker that you can take anywhere you like and use whenever you want to, so it will not disrupt the atmosphere of your room.

### Related links

[“Playing surround sound of the sound bar” \(p.14\)](#)

# ACCESSORIES

## Included accessories

Make sure you have received all of the following accessories:

- USB cable (for charging this unit; 1 m, Type-A to Type-C) (×1)

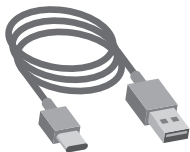

- Additional Information (TRUE X SURROUND) (×1)



- Quick Guide (×1)



- Safety Guide (×1)



# PART NAMES AND FUNCTIONS

## Top controls/Front

This section describes the names and functions of the controls.

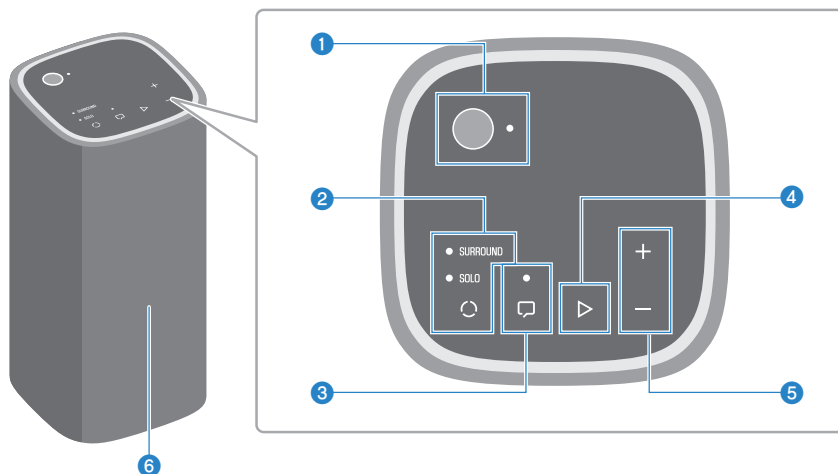

### 1 Power button and lamp

Turn the wireless speaker on and off. The power lamp informs you of the remaining battery level or the status of the power.

### 2 (mode) button and lamps

The unit's mode changes each time this button is pressed. The SURROUND or SOLO lamp shows the selected mode.

- SOLO: This mode is used when using this unit alone as a Bluetooth speaker (p.12).
- SURROUND: This mode is used when using the unit in combination with a Yamaha sound bar (p.14).

### 3 (Clear Voice) button and lamp

Enable or disable the Clear Voice function (available only when in SOLO mode).

When the Clear Voice function is enabled, the Clear Voice lamp glows, and human voices such as dialog can be heard more easily.

### 4 (play/pause) button

Audio is played or paused each time this button is pressed.

During playback, press the button twice quickly to skip to the next song, or three times to skip backward to the beginning of the current song or previous song.

### 5 Volume (+/-) buttons

Adjust the volume.

**6 Speaker**

## Rear/Bottom

This section describes the part names and functions of the rear and bottom of the unit.

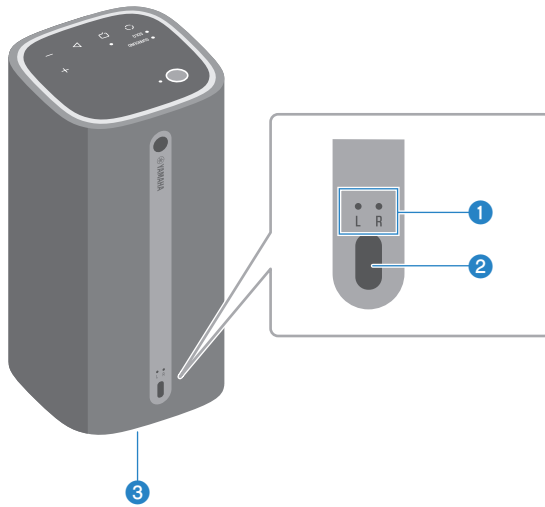

### 1 L/R lamps

The lamps glow to show the setting status when the sound bar is connected.

- L lamp glows: The wireless speaker is set to output surround left sound (back left channel).
- R lamp glows: The wireless speaker is set to output surround right sound (back right channel).
- L and R lamps glow: The single wireless speaker is set to output both surround left and surround right sounds.

### 2 USB port (Type-C)

Connect the included USB cable (for charging this unit) (p.9).

### 3 Charging terminal (bottom)

Use when charging the unit by placing it on a charging cradle (Yamaha CC-T1A; sold separately).

## Related links

“Playing surround sound of the sound bar” (p.14)



# PREPARATION

## Charging the unit

Use a commercially available USB power adapter that can output DC 5 V (2 A or more) when charging the unit.

A charging cradle (Yamaha CC-T1A; sold separately) can also be used to charge the unit.



### CAUTION

- Do not charge the unit when it is wet. Charging with liquid or foreign matter on the terminals may cause fire, explosion, battery fluid leakage, electric shock, or malfunction.

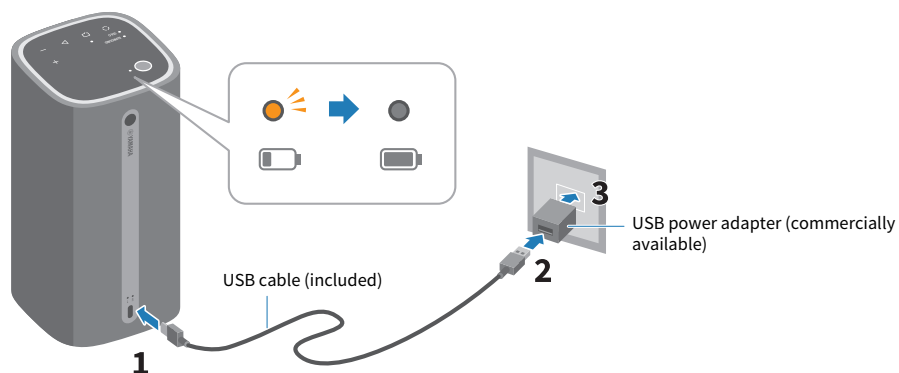

**1** Connect the Type-C connector of the USB cable to the USB port on this unit.

**2** Connect the Type-A connector of the USB cable to the USB power adapter.

**3** Plug in the USB power adapter to an AC wall outlet.

The power lamp glows orange and charging will start. When charging is completed, the power lamp turns off.

### NOTE

- When charging with a DC 5 V (2 A or more) USB power adapter, the charging time is as follows: Charging time varies depending on the usage environment and conditions.
  - WS-X3A: approx. four hours
- If the unit is playing at a high volume while it is being charged, the remaining battery may decrease. Turn down the volume, or turn off the unit and wait until charging is complete before using it.
- Not all commercially available USB power adapters are guaranteed to be compatible with this product.

## Turning the unit on and off (standby)

To turn the unit on/off, follow the instructions below.

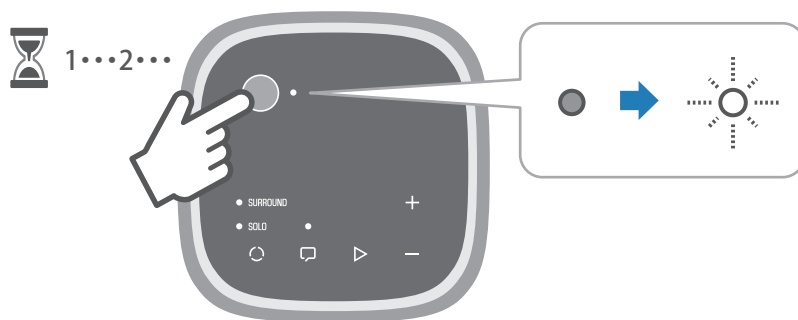

### Press and hold the power button to turn the power on.

The power lamp flashes to inform you of the remaining battery level.

- Flashing white: Remaining battery level is more than half.
- Flashing orange: Remaining battery level is less than half.

After showing the remaining battery level, the unit turns on. To turn off the unit, press and hold the power button again.

### Related links

“Restarting or initializing (factory reset) the unit” (p.23)

### ■ Checking the remaining battery level

If the play/pause (▷) button is pressed and held for at least five seconds while the unit is on, the power lamp and a melody inform you of the remaining battery level.

Remaining battery level	Power lamp	Melody
More than half	Flashes white	Long sound
Less than half	Flashes orange	Medium length sound
Less than 20%		Short sound

## PREPARATION > Turning the unit on and off (standby)

### NOTE

- This unit will automatically switch to standby in any of the following situations (Auto Standby):
  - When SOLO mode is selected
    - No playback and no control operations for 20 minutes or more
    - No control operations for eight hours or more, regardless of playback
  - When SURROUND mode is selected
    - Not connected to the sound bar for 20 minutes or more
    - The sound bar is turned off while the unit is connected to the sound bar
- A melody will inform you of the status of this unit, such as when the power is turned on or when a Bluetooth device is connected. (Sound Guide: Enabled by default.)
  - To disable the Sound Guide, hold down the Clear Voice button for at least three seconds. Sound Guide switches between enabled and disabled each time the button is held down.

### Related links

“Top controls/Front” (p.6)

# USING THIS UNIT AS A BLUETOOTH® SPEAKER

## Listening to audio from a Bluetooth device

A Bluetooth device can be connected when the SOLO lamp is flashing blue.

If the unit has been connected to a sound bar as a surround speaker, change the unit's mode to SOLO using the mode (○) button.

### NOTE

- If other Bluetooth devices have been connected before, the unit will automatically connect to the last connected device when the unit is turned on. To connect a new Bluetooth device, disconnect the currently connected Bluetooth device and then connect the new device.
- To terminate the Bluetooth connection from this unit, press the volume (-) button and play/pause (>) button simultaneously for at least five seconds.

**1 On the Bluetooth device, enable the Bluetooth function.**

**2 On the Bluetooth device, select this unit (Yamaha WS-\*\*) from the list of available devices to connect to.**

The model name of your product (X3A) is displayed in place of \*\*. If a passkey is required, enter the number "0000".

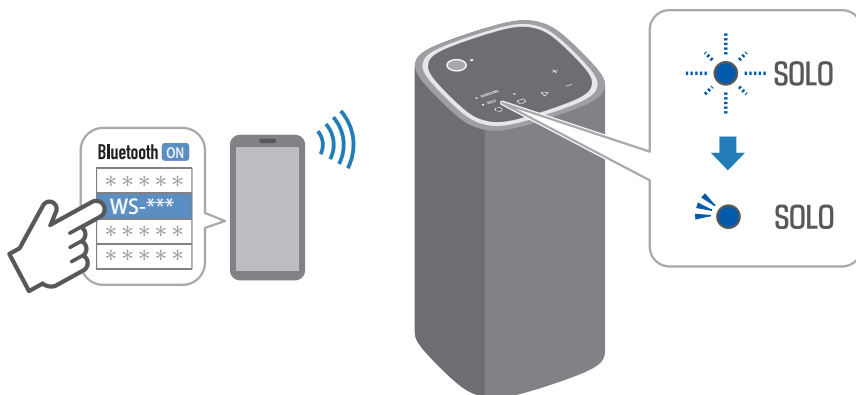

When the connection is established, the SOLO lamp glows blue.

### 3 Start playback of audio on the Bluetooth device.

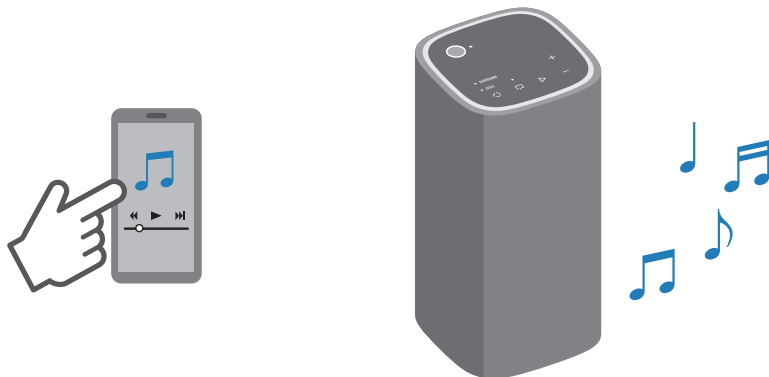

#### Related links

"PART NAMES AND FUNCTIONS" (p.6)

## USING THIS UNIT AS A SURROUND SPEAKER

### Playing surround sound of the sound bar

Real surround sound can be achieved just by using this unit as a surround speaker for the sound bar.

For information on compatible Yamaha sound bars and connection methods, visit the following website:

[https://manual.yamaha.com/audio/sound\\_bar/sr-x90a/truexsur.html](https://manual.yamaha.com/audio/sound_bar/sr-x90a/truexsur.html)



# TROUBLESHOOTING

## When a problem occurs

### Check the following first when any problem occurs

---

Try following the instructions described in “When a problem occurs” first when the unit does not function properly. If an error occurs, the lamp flashes to notify you.

- “List of lamp displays” (p.24)

If the unit does not function properly after following the instructions to solve the problem, restart or initialize it.

- “Restarting or initializing (factory reset) the unit” (p.23)

If the unit still does not function properly even after doing so, turn off the unit and contact the nearest authorized Yamaha dealer or service center.

#### **When this unit is connected to the sound bar**

See also the following guide when this unit is connected to a sound bar.  
[https://manual.yamaha.com/audio/sound\\_bar/sr-x90a/truexsur.html](https://manual.yamaha.com/audio/sound_bar/sr-x90a/truexsur.html)

## **The unit cannot be charged/It takes a long time to charge**

---

● **A USB power adapter that is not compatible with the unit is being used.**

Use a USB power adapter that can output DC 5 V (2 A or more).

- “Charging the unit” (p.9)

● **The USB power adapter’s output is not stable.**

Not all commercially available USB power adapters are guaranteed to be compatible with this product.

Try using a different USB power adapter.

● **The USB power adapter and this unit are not properly connected.**

Check that all connections are made properly.

- “Charging the unit” (p.9)

● **Ambient temperature is too high or too low.**

Charge the unit within its temperature range for usage (5°C to 35°C).

- “Charging the unit” (p.9)

● **Charging is taking a long time.**

It is possible that charging is stopped. Disconnect and reconnect the included USB cable and charge the unit again.

- “Charging the unit” (p.9)

● **The protection circuitry of this unit has been activated.**

Check the lamp display.

- “List of lamp displays” (p.24)

● **The unit is connected to a USB charging compatible port on a computer.**

Charging from a USB port of a computer is not guaranteed to work. Use a USB power adapter that can output DC 5 V (2 A or more).



## The unit cannot be turned on

---

● **The power button is not being pressed and held.**

To turn on the unit, press and hold the power button for at least three seconds.

- “Turning the unit on and off (standby)” (p.10)

● **The remaining battery level is low.**

Charge the unit.

- “Charging the unit” (p.9)

● **Ambient temperature is too high or too low.**

Use the unit within the operating temperature range.

- “SPECIFICATIONS” (p.26)

## The unit turns off suddenly

---

● **The remaining battery level is low.**

Charge the unit.

If the unit is playing at a high volume, the remaining battery may decrease and the unit may turn off even if it is charging. In this case, turn off the unit, and then fully charge it before use.

- “Charging the unit” (p.9)

● **The Auto Standby function turned off the unit.**

Turn on the unit again.

- “Turning the unit on and off (standby)” (p.10)

● **Ambient temperature is too high or too low.**

Use the unit within the operating temperature range.

- “SPECIFICATIONS” (p.26)

● **The sound bar that is connected to the unit has been turned off.**

Turning the sound bar on and off turns the unit on and off when the unit is connected to the sound bar.

- [https://manual.yamaha.com/audio/sound\\_bar/sr-x90a/truexsur.html](https://manual.yamaha.com/audio/sound_bar/sr-x90a/truexsur.html)

● **The USB power adapter’s output is not stable.**

Turn down the volume or try using a different USB power adapter. Not all commercially available USB power adapters are guaranteed to be compatible with this product.

● **The rechargeable battery in the unit has deteriorated.**

If the unit turns off immediately even after fully charging, the rechargeable battery may be deteriorated. Contact the nearest authorized Yamaha dealer or service center.

## The unit cannot be connected to a Bluetooth device

---

● **The name of this unit is not displayed in the list of available devices to connect to on the Bluetooth device.**

Try disabling and re-enabling the Bluetooth function of the Bluetooth device. The name of this unit may then be displayed.

● **This unit cannot be connected to the Bluetooth device even though the name of the unit is displayed in the list of available devices to connect to on the Bluetooth device.**

Try deleting this unit from the list and connecting the unit to the Bluetooth device again. It may then be possible to connect to the Bluetooth device.

● **The Bluetooth device is not turned on.**

Ensure that the Bluetooth device is turned on and that its Bluetooth function is enabled.

● **The unit is connected to another Bluetooth device.**

Terminate the current Bluetooth connection, and then connect to the new device.

- “Listening to audio from a Bluetooth device” (p.12)

● **The unit and the Bluetooth device are too far away from each other.**

Move the Bluetooth device and/or the unit so that they are closer to each other.

● **The audio output destination on the Bluetooth device is not set to this unit.**

Select this unit as the audio output destination on the Bluetooth device.

● **Electromagnetic waves being emitted from devices using the 2.4 GHz frequency band (such as microwave ovens or wireless routers) are obstructing the wireless communication.**

Do not use the unit near such devices.

● **This unit has been initialized.**

The connection information will be deleted when the unit is initialized. Delete this unit from the list of available devices to connect to on the Bluetooth device and then connect to the Bluetooth device again.

- “Listening to audio from a Bluetooth device” (p.12)

● **The passkey for the Bluetooth device is not “0000”.**

Bluetooth devices with a passkey other than “0000” cannot be used.

● **The Bluetooth device you are using does not support the A2DP profile.**

Use a Bluetooth device that supports the A2DP profile.

## No sound

---

● **The unit and Bluetooth device are not connected.**

Connect to the Bluetooth device.

- “Listening to audio from a Bluetooth device” (p.12)

● **The volume is too low**

Turn up the volume.

- “Top controls/Front” (p.6)

## **Broken, distorted, or unusual sound is heard from the unit**

---

● **The volume is too high.**

Turn down the volume.

- “Top controls/Front” (p.6)

● **Electromagnetic waves being emitted from devices using the 2.4 GHz frequency band (such as microwave ovens or wireless routers) are obstructing the wireless communication.**

Do not use the unit near such devices.

● **The unit and the Bluetooth device are too far away from each other.**

Move the Bluetooth device and/or the unit so that they are closer to each other.

## **Noise is emitted from electronic devices installed near the unit**

---

- **The Bluetooth connection is unstable.**

Install this unit away from electronic devices.

## Restarting or initializing (factory reset) the unit

If the unit does not function properly after following the instructions described in “When a problem occurs”, restart or initialize (factory reset) the unit.

### ■ Restarting the unit

Press and hold the power button for at least 10 seconds to restart the unit. The connection information will not be deleted even if the unit is restarted.

If the unit does not turn on automatically after restarting, press and hold the power button for at least three seconds to turn on the unit.

### ■ Initializing the unit

If the unit does not function properly even after restarting, initialize it. When the unit is initialized, the factory settings will be restored and all connection information will be deleted.

#### **1 Press the power button while holding down the Clear Voice button in standby state.**

The Clear Voice lamp flashes.

#### **2 Press the play/pause button while the Clear Voice lamp is flashing.**

The unit will be initialized.









After initializing, press and hold the power button for at least three seconds to turn on the unit.

### **Related links**





“When a problem occurs” (p.15)

## List of lamp displays

The status of this unit is shown by the color of the lamp (white, blue, or orange) and by glowing/flashing.

Power lamp	Power status	Status of the unit	Solution
 Flashes white	On	In the process of starting up	—
 Glowing white	On	—	—
 Glowing white brightly and dimly alternately	On	Charging	—
 Off	Standby	Charging is completed. The unit is in standby state.	—
 Glowing orange	Standby	Charging	—
 Flashes orange four times repeatedly	On	Remaining battery level is less than 20%.	Charge the unit.
SOLO lamp	Power status	Status of the unit	Solution
 Glowing blue	On	Connected to a Bluetooth device	—
 Flashing blue	On	Waiting for the Bluetooth connection	—



Power lamp	Power status	Status of the unit	Solution	
 Flashing orange	On/Standby (in charging state)	An error occurred*	Unplug the USB power adapter from the AC wall outlet, and then plug it in again after 5 to 10 minutes.	
 Flashing orange and white alternately	On	An error occurred*	Turn off the unit, and then turn it on again after 5 to 10 minutes.	
Power lamp	Clear Voice lamp	Power status	Status of the unit	Solution
 The power lamp and Clear Voice lamp are flashing.		On/Standby	An error occurred*	Unplug the USB power adapter from the AC wall outlet, and then plug it in again. If the lamps are still flashing, restart the unit.

\* If an error occurs and the unit does not function properly even after following the instructions to solve the problem, turn off the unit and contact the nearest authorized Yamaha dealer or service center.

#### When the unit is connected to the sound bar

See also the following guide when this unit is connected to a sound bar.  
[https://manual.yamaha.com/audio/sound\\_bar/sr-x90a/truexsur.html](https://manual.yamaha.com/audio/sound_bar/sr-x90a/truexsur.html)

#### Related links

“Restarting or initializing (factory reset) the unit” (p.23)

# APPENDIX

## SPECIFICATIONS

### Bluetooth

---

Bluetooth version	Bluetooth Version 5.0
Supported profiles	A2DP (Advanced Audio Distribution Profile) AVRCP (Audio/Video Remote Control Profile)
Maximum communication range	10 m (33 ft) (without interference)

### Power

---

Built-in rechargeable battery	Lithium-ion battery
Continuous playback time	SOLO mode: approx. 12 hours when fully charged (IEC62396-1) SURROUND mode: approx. 10 hours when fully charged (IEC62396-1)
Charging time	Approx. four hours (Playback/charging time varies depending on the usage environment and conditions.)
Input	DC 5 V, 2 A

### General

---

Dimensions (W × H × D)	88 × 220 × 88 mm (3-1/2" × 8-5/8" × 3-1/2")
Weight	0.99 kg (2.18 lb)
Waterproof and dustproof performance	IP67
Charging temperature range	5°C to 45°C
Operating temperature range	5°C to 35°C

## Trademarks



The Bluetooth® word mark and logos are registered trademarks owned by Bluetooth SIG, Inc. and any use of such marks by Yamaha Corporation is under license. Other trademarks and trade names are those of their respective owners.

Yamaha Global Site  
<https://www.yamaha.com/>

Yamaha Downloads  
<https://download.yamaha.com/>

© 2025 Yamaha Corporation

Published 07/2025 NV-A1

AV24-0029