



# SILENT BRASS™

## Pickup Mute™

取扱説明書

Owner's Manual

Bedienungsanleitung

Mode d'emploi

Manual de instrucciones

使用说明书

Руководство пользователя

사용설명서

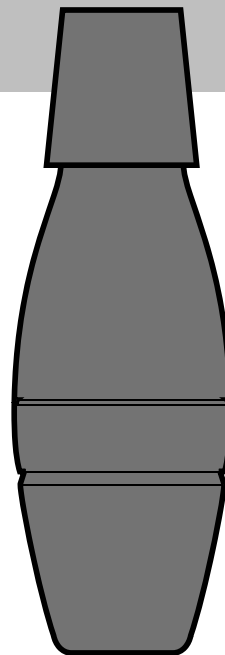

日本語

English

Deutsch

Français

Español

中文

Русско

한국어



# SILENT BRASS™

## Pickup Mute™

*Thank you for purchasing the Yamaha SILENT BRASS™ Pickup Mute™. In order to obtain the maximum performance and enjoyment from your Pickup Mute™, we urge you to read this Owner's Manual thoroughly before using. Please keep this Owner's Manual in a safe place for later reference.*



## Contents of Set

- Pickup Mute™ PM9/PM7/PM6/PM5/PM3/PM2/PM1
- Cable
- Owner's Manual

*\* Personal Studio™ ST9 is not included.*

## ■ Pickup Mute™ Specifications

Pickup Mute™	Instrument	Dimensions (diameter x length)	Width at handle	Weight
PM9	Piccolo Trumpet	70 x 145 mm (2-3/4" x 5-11/16")	—	80g (2.8oz.)
PM7	Trumpet, Cornet	70 x 200 mm (2-3/4" x 7-7/8")	—	120g (4.2oz.)
PM6	Flugelhorn, Alto Trombone	108 x 270 mm (4-1/4" x 10-5/8")	—	270g (9.5oz.)
PM5	Trombone, Bass Trombone		—	
PM3	French horn		150mm	300g (10.5oz.)
PM2	Euphonium	190 x 410 mm (7-1/2" x 16-1/8")	220mm	800g (1lbs.,12oz.)
PM1	Tuba	380 x 980 mm (14-15/16" x 38-9/16") * assembled size	430mm	2900g (6lbs.,6oz.)

- Common specifications for all models: Internal Microphone: Electric condenser microphone, Nominal Level: -25dB to -35dB, Material: ABS resin

*\* Specifications and design are subject to change without notice.*

**Your Pickup Mute™ will give you years of reliable service if you follow the simple rules given below:**

■ **Location**

Do not expose it to the following conditions to avoid deformation, discoloration, or more serious damage.

- Direct sunlight (e.g. near a window).
- High temperatures (e.g. near a heat source, outside, or in a car during the daytime).
- Excessive humidity.
- Excessive dust.
- Strong vibration.

■ **Handling and Transport**

- Never apply excessive force to the controls, connectors or other parts.
- Always unplug cables by gripping the plug firmly, not by pulling on the cable.
- Disconnect all cables before moving the unit.
- Physical shocks caused by dropping, bumping, or placing heavy objects on the unit can result in scratches and more serious damage.

■ **Cleaning**

- Clean the cabinet and panel with a dry soft cloth.
- A slightly damp cloth may be used to remove stubborn grime and dirt.
- Never use cleaners such as alcohol or thinner.

YAMAHA is not responsible for damage caused by improper handling or operation.

## **SPECIAL MESSAGE SECTION**

### **SPECIFICATIONS SUBJECT TO CHANGE:**

The information contained in this manual is believed to be correct at the time of printing. However, Yamaha reserves the right to change or modify any of the specifications without notice or obligation to update existing units.

Do not attempt to service this product beyond that described in the user-maintenance instructions. All other servicing should be referred to qualified service personnel.

This product, either alone or in combination with an amplifier and headphones or speaker/s, may be capable of producing sound levels that could cause permanent hearing loss. DO NOT operate for long periods of time at a high volume level or at a level that is uncomfortable. If you experience any hearing loss or ringing in the ears, you should consult an audiologist.

**IMPORTANT:** The louder the sound, the shorter the time period before damage occurs.

### **NOTICE:**

Service charges incurred due to a lack of knowledge relating to how a function or effect works (when the unit is operating as designed) are not covered by the manufacturer's warranty, and are therefore the owner's responsibility. Please study this manual carefully and consult your dealer before requesting service.

### **Disposal Notice:**

Should this product become damaged beyond repair, or for some reason its useful life is considered to be at an end, please observe all local, state, and federal regulations that relate to the disposal of products that contain lead, batteries, plastics, etc. If your dealer is unable to assist you, please contact Yamaha directly.

92-BP



# Set up and Use

## ■ Personal Studio™ ST9

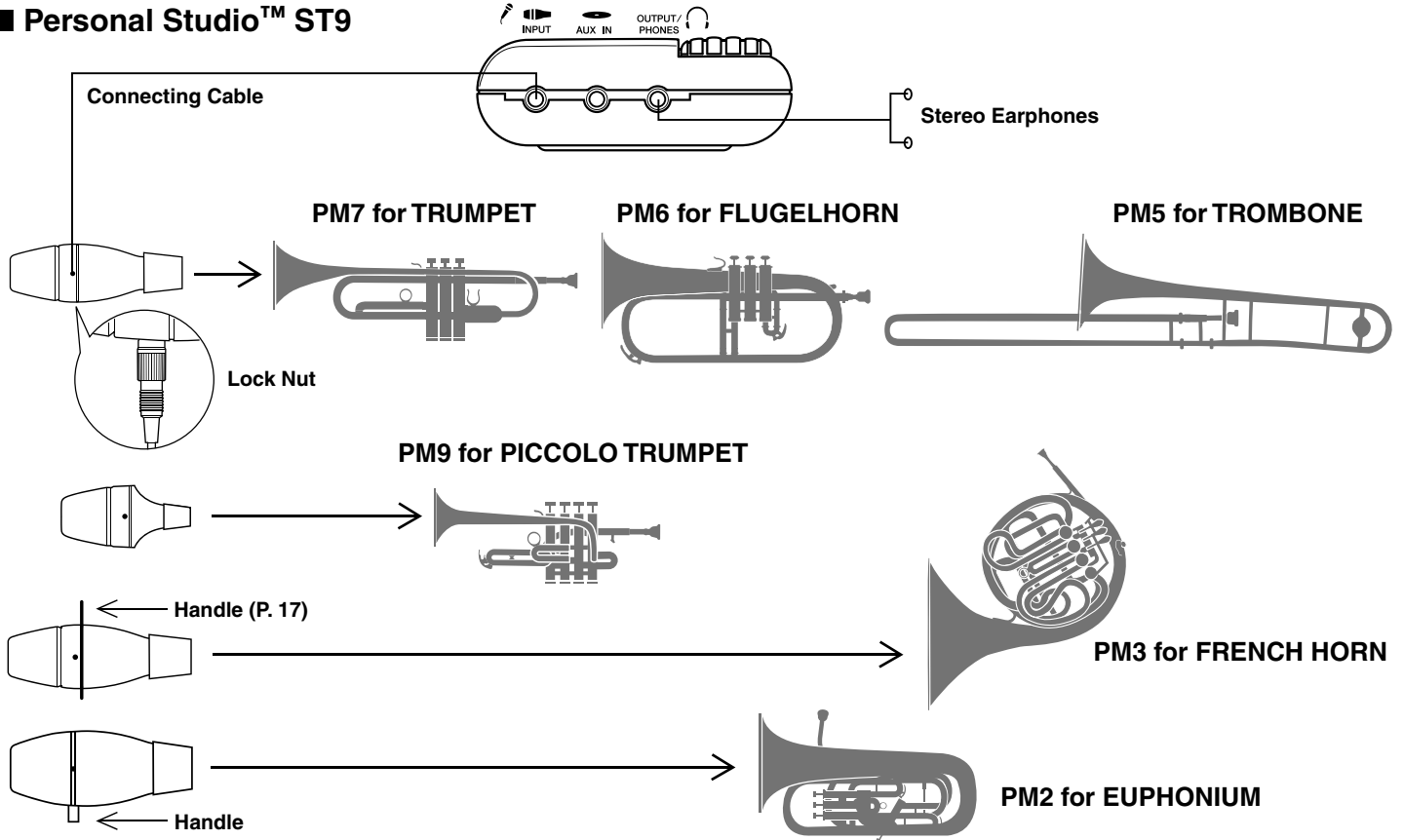

**!** Before connecting the cable and attaching the Pickup Mute™, make sure the power is switched OFF and the earphones are removed from your ears.

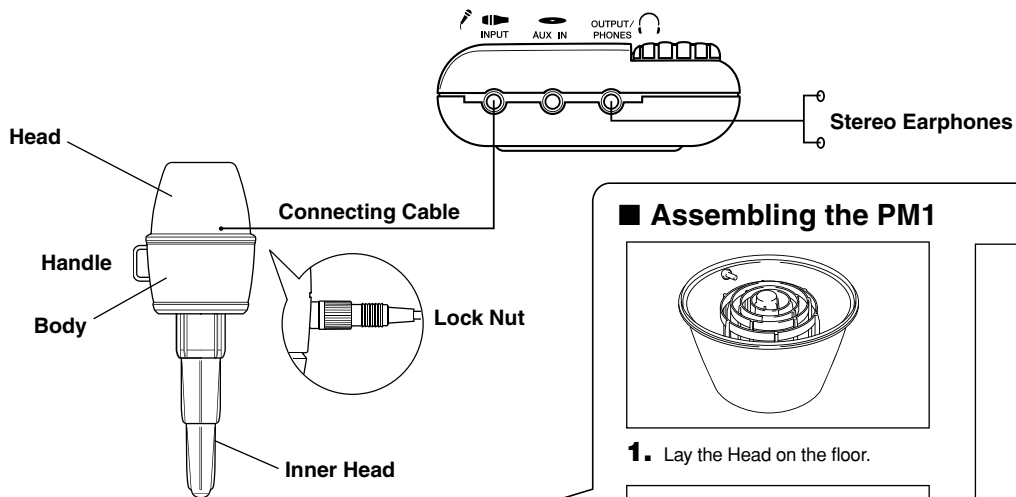

### ■ Assembling the PM1

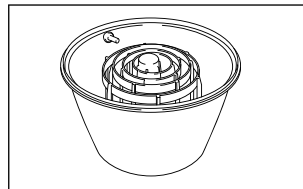

**1.** Lay the Head on the floor.

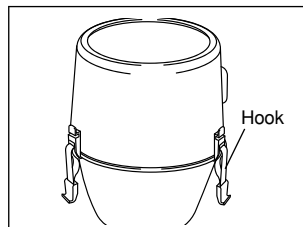

**2.** Place the Body on the Head and fasten with the three hooks.

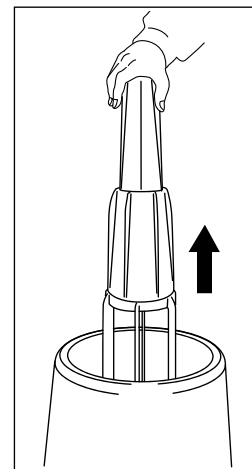

**3.** Fully extend the Inner Head that is located in the center of the Head.

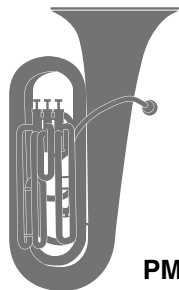

**PM1 for TUBA**

*\* Refer to pg.16 for instructions on attaching the Pickup Mute™ to the instrument.*



# QUICK GUIDE

## Attaching and removing the Pickup Mute™ PM9/PM7/PM6/PM5/PM3

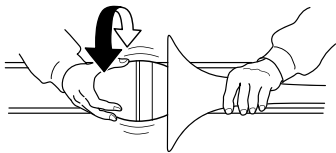

As shown in the illustration, hold the instrument with your left hand and, while turning the Pickup Mute™, firmly insert it into the bell with your right hand.

## Attaching the Pickup Mute™ to the Euphonium

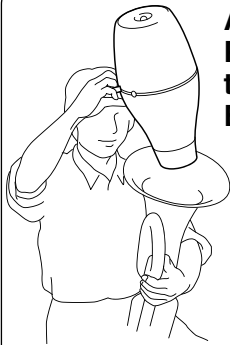

For Euphoniums, with the bell facing up, hold the PM2 by its handle in your right hand and firmly insert it into the bell.

## ■ Attach the Pickup Mute™ PM1 to the Tuba

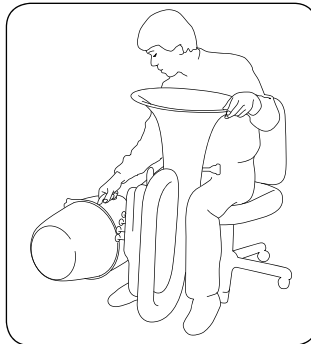

**1.** After assembling the PM1 (refer to pg. 15) lay it on its side. While seated, hold the tuba between your legs. Hold the PM1 by its handle and lift it up.

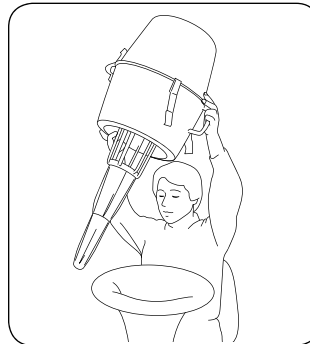

**2.** Holding the PM1 with both hands, gently insert the Inner Head into the bell of the tuba. (Continue holding the tuba between your legs.)

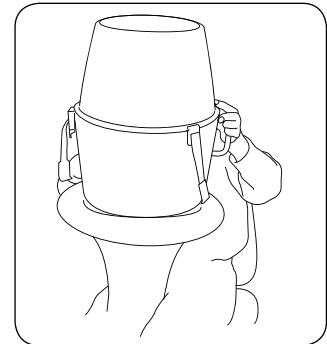

**3.** Adjust the PM1 so that it is positioned in the center of the bell.  
*\* Noise will result if the Inner Head is touching the bell.*

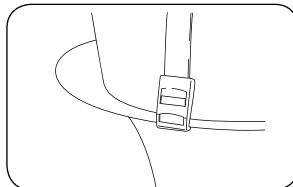

**4.** Attach the PM1 fixing hooks to the bell. If necessary, adjust the length (tension) of the hook to belt.

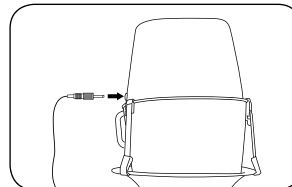

**5.** Connect the lock nut equipped end of the supplied cable to the PM1's output jack and secure the lock nut.

**!** After removing the PM1 from the instrument, lay the PM1 on its side. If the PM1 is stood vertically, the Inner Head will collapse causing a burst of noise in the earphones that may result in hearing impairments.

**⊘** When putting the PM1 away, hold the Inner Head with both hands and gently collapse it back into the Body. Strongly dropping the Inner Head may result in damage to the PM1.

## Holding the Pickup Mute™ when playing the horn standing up

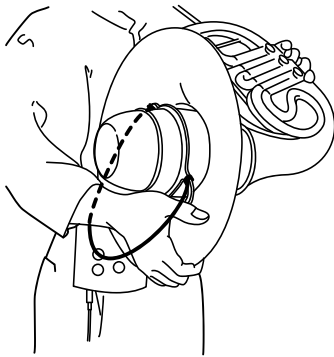

As shown in the illustration, lightly support the handle in the middle of the Pickup Mute™ with the ball of your thumb while holding the instrument at the bell rim with your other fingers. The handle also features a ring for a wrist band, allowing you to hang the Pickup Mute™ from your wrist (just like any other mute) while emptying the horn. (Wrist band is not included.)

*\* Always remove the Pickup Mute™ before emptying the instrument.*



The following cautions are for your own safety and to avoid possible damage to and malfunctioning of the equipment, and thus should be observed carefully.

- Firmly insert the Pickup Mute™ into the bell of the instrument.
- Avoid dropping the Pickup Mute™. Dropping the mute may result in damage. Also, shock to the ear from the noise produced by dropping the mute may result in damage to your hearing.
- Do not touch or jab the Pickup Mute™'s microphone component.

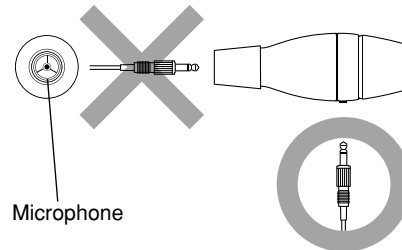

Microphone

- Avoid stepping on the cable.
- When you are finished playing, remove the Pickup Mute™ from the instrument. Clean any moisture on the Pickup Mute™ with a cloth. **DO NOT WASH WITH WATER.**
- If moisture gets on the Pickup Mute™ during or after playing, please dry thoroughly.

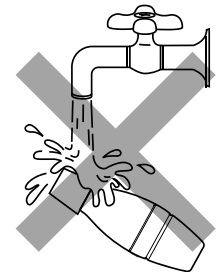





# QUICK GUIDE

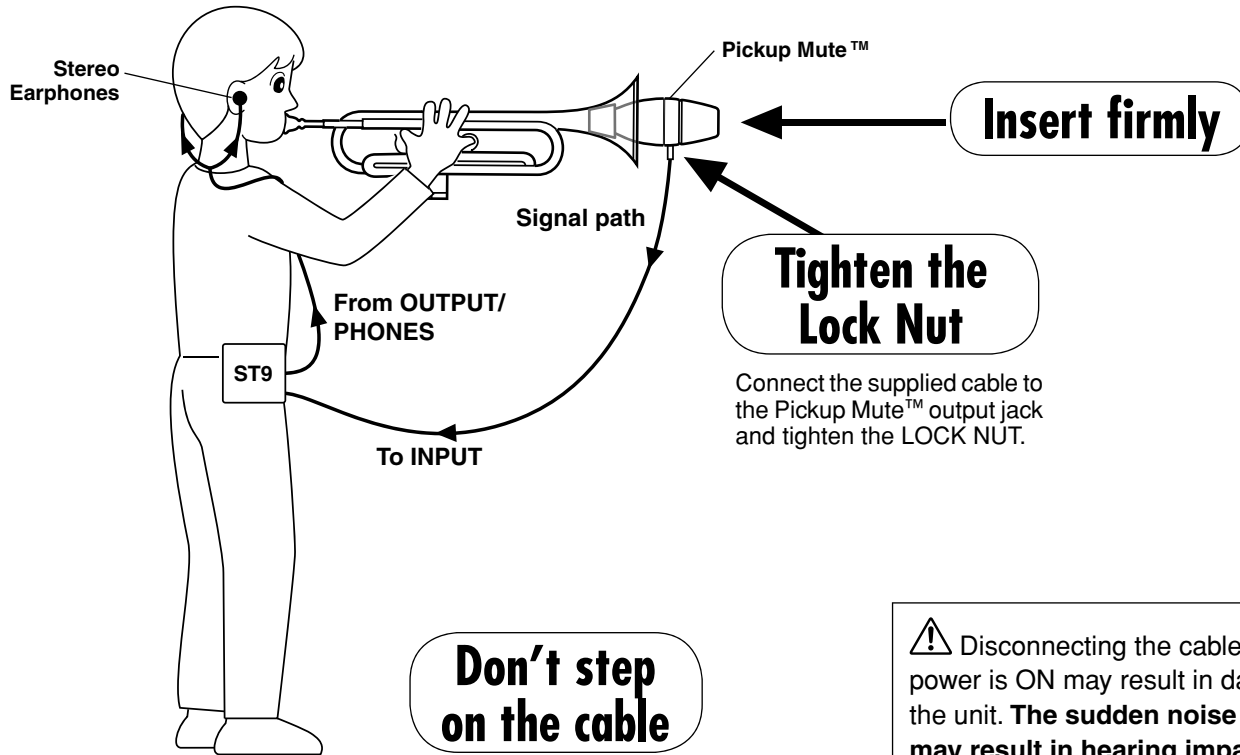

Connect the supplied cable to the Pickup Mute™ output jack and tighten the LOCK NUT.

 Disconnecting the cable while the power is ON may result in damage to the unit. **The sudden noise may also may result in hearing impairments.**

**Do not disturb your neighbours during late hours.**

\* Personal Studio™ ST9 and stereo earphones are not included.